

Project Name:	
Type:	

RCEL-800

Exit Sign & Emergency Lighting
Wireless Reporting Compatible

PRODUCT FEATURE

- Recessed ceiling and recessed wall mount
- Full angle adjustable lamp head
- High temperature long life Ni-MH battery
- Extrusion aluminium alloy trim plate
- Acrylic panel changeable design
- 6" height letter
- Suitable for damp location
- Slim type design
- Self-test/self-diagnostics function available
- Remote capability design with additional battery
- 30 Degree beam angel
- Compatible with LynxEM™ testing/reporting system

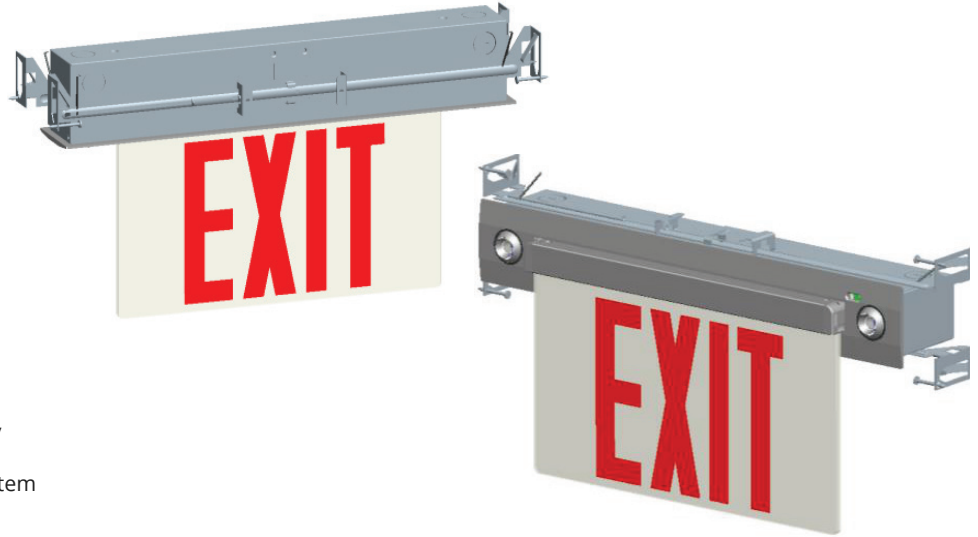

TECHNICAL SPECIFICATION

TECHNICAL SPECIFICATION

Rated Power Supply	:	120/277 VAC 60Hz
Charge Time	:	24 hours
Discharge duration	:	1.5 hours
Test facility	:	Manual test/ Self-test/ LynxEM™ testing
Mounting	:	Recessed ceiling and recessed wall
LED	:	High power LED for lamp head, SMD LED for sign
Luminance of safety sign	:	Meet UL 924
Ambient temperature	:	10°C - 40°C, suitable damp location
Insulation Class	:	Class I
Certification	:	UL 924

RELATED PRODUCTS

- ◊ [SCEL8000 Emergency Light](#)
- ◊ [EXL-700 Emergency Lighting](#)
- ◊ [EXL-1960 Emergency Lighting](#)

WARRANTY

- See [Limited Warranty Policy](#) for more additional information

ORDER INFORMATION: EXAMPLE: RCEL-800-S-R(G)-XX-ZD-HO-RC-U

MODEL	FACE	LETTER	EXIT PLATE FINISHED	TRIM PLATE FINISHED	SELF-DIAGNOSTICS	BATTERY CAPACITY	REMOTE CAPABILITY	PANEL NUMBER
RCEL-800	S Single face D Double face	R Red G Green	BLANK Clear (M) Mirrored	AL Aluminum WH White BK Black	BLANK Standard Circuitry CT Self-diagnostic ZD CT with LynxEM™ Wireless Testing Reporting System	BLANK 3.6V 1800mAh 250Lm output HO 3.6V 2500mAh 400Lm output	BLANK No Remote Capability RC 3.6V max. 3W remote capability	BLANK Standard Type U Providing additional EXIT Panel

- * Double Face (only for mirror background)
- * Single Face (both for clear and mirrored background)

PRODUCT DIMENSION

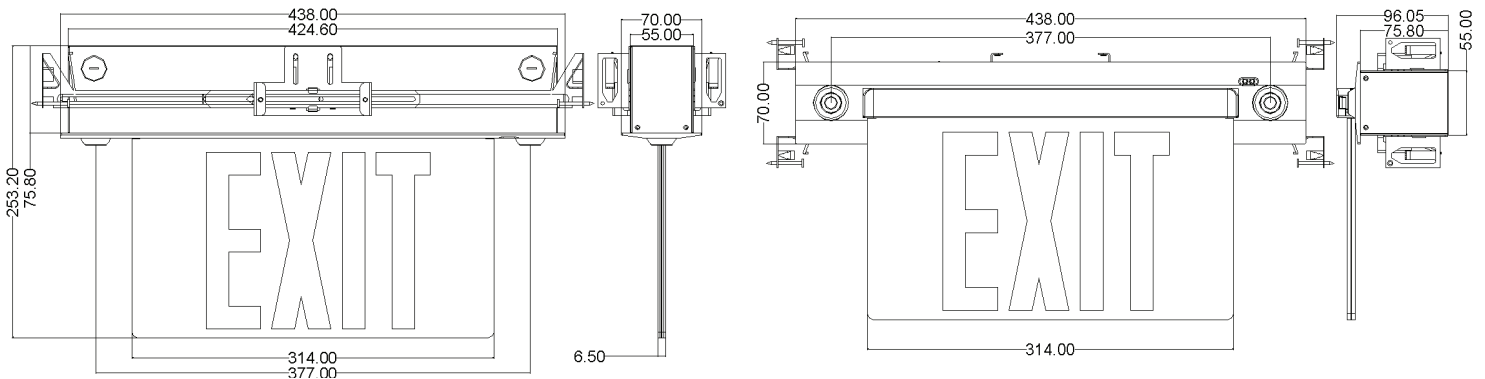

RCEL-800

Exit Sign & Emergency Lighting
Wireless Reporting Compatible

LUMINOUS INTENSITY DISTRIBUTION

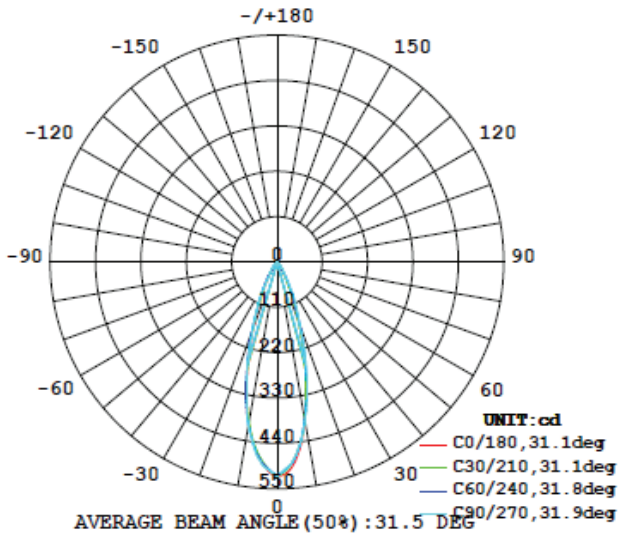

Project Name:	
Type:	

CENTER TO CENTER SPACING

NFPA 101 requires 1.0 foot-candle average and 0.1 foot-candle minimum with a 40:1 maximum/minimum ratio. The corridor used is 100 feet long, 9 feet ceiling with a 6 feet wide walkway and 3 feet path of egress.

The reflectance are 80% ceiling, 50% walls and 20% floor. The fixture mounting height is 7.5 feet.

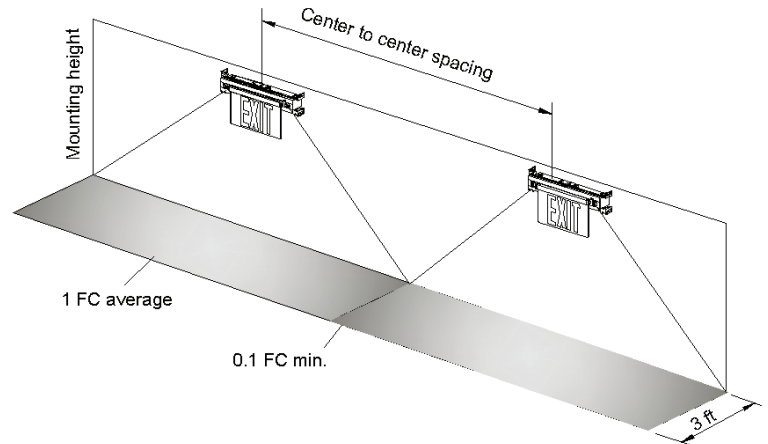

No.	MODEL	SPACING @ 7.5 FEET MOUNTING HEIGHT	SPACING @ 10 FEET MOUNTING HEIGHT
1	RCEL-800-X	34 feet	40 feet
2	RCEL-800-X-HO	42 feet	48 feet

PRODUCT INSTALLATION EXPLODED

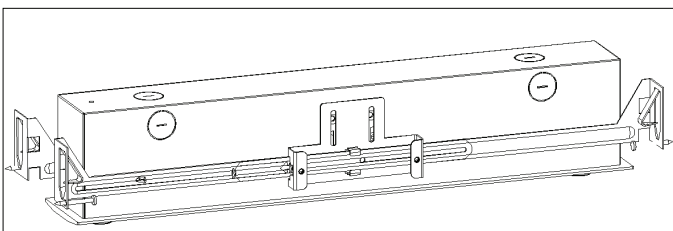

Step 1: Install canopy to junction box.

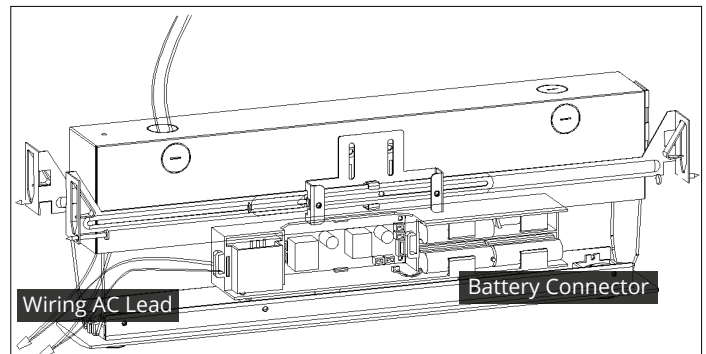

Step 2: Separate trim module and connect battery connector to PCBA

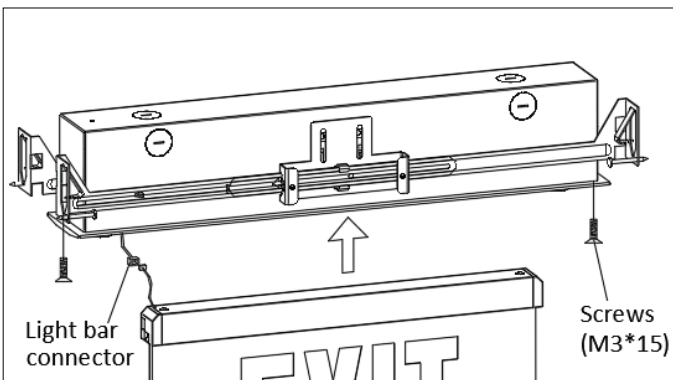

Step 3: Push the unit back to the junction box, assembly panel module.

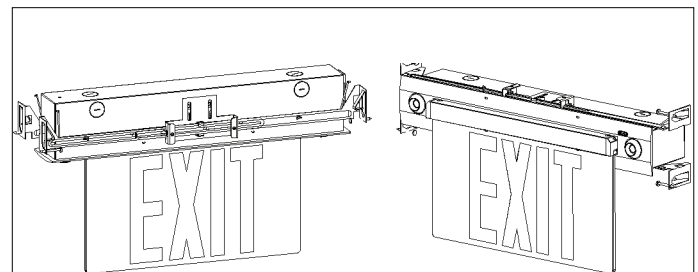

Step 4: Ceiling or surface mount for panel module.

Project Name:	
Type:	

RCEL-800

Exit Sign & Emergency Lighting
Wireless Reporting Compatible

RECESSED CEILING OR RECESSED WALL MOUNT

RECESSED CEILING MOUNT

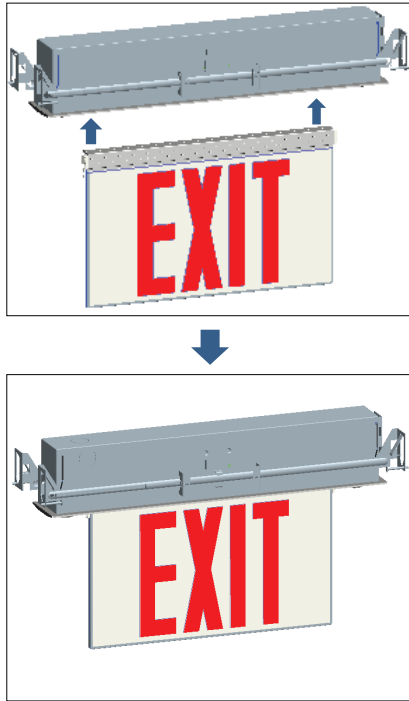

RECESSED WALL MOUNT

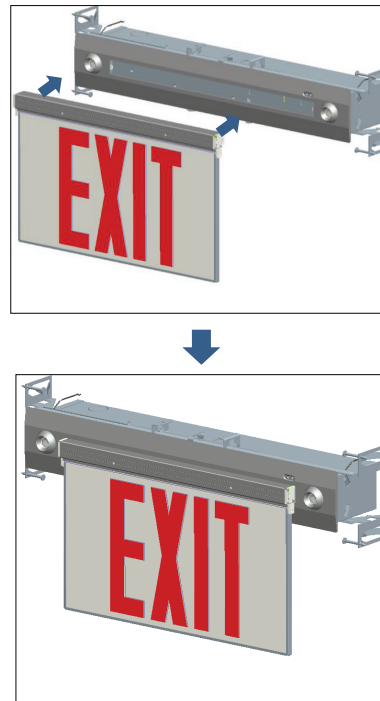

PACKAGING

INNER BOX : 475 x 215 x 110mm
 CARTON BOX : 490 x 445 x 240mm
 QTY : 4 PCS
 N.W : 9.10 KGS
 G.W : 11.2 KGS
 MEA'S : 1.88 CUFT

