

Project Name:	
Type:	

SCEL-8000

Exit Sign & Emergency Lighting

PRODUCT FEATURE

- Surface wall and surface ceiling mount
- Full angle adjustable lamp head
- High temperature long life Ni-MH battery
- Extrusion aluminium alloy trim plate
- Acrylic panel changeable design
- 8" height letter
- Suitable for damp location
- Slim type design
- Self-test/self-diagnostics function available
- Remote capability design with additional battery
- 30 Degree beam angel
- Compatible with LynxEM™ testing/reporting system.

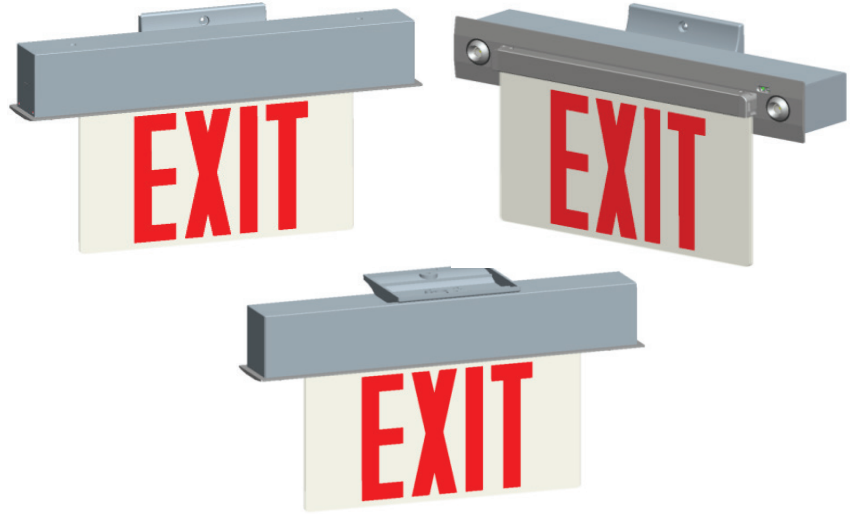

TECHNICAL SPECIFICATION

Rated Power Supply	:	120/277 VAC 60Hz or 120/347 VAC 60Hz
Charge Time	:	24 hours
Discharge duration	:	1.5 hours
Test facility	:	Manual test/ Self-test/ LynxEM™ testing
Mounting	:	Surface wall and surface ceiling
LED	:	High power LED for lamp head, SMD LED for exit sign
Luminance of safety sign	:	Meet UL 924
Ambient temperature	:	10°C - 40°C, suitable damp location
Insulation Class	:	Class I
Certification	:	UL 924

RELATED PRODUCTS

- ◊ [EXL-1960 Emergency Lighting](#)
- ◊ [REM8000 Emergency Light](#)
- ◊ [RCEL800 Emergency Lighting Combo](#)
- ◊ [S3 Series – Exit Sign](#)

WARRANTY

- See [Limited Warranty Policy](#) for more additional information

ORDER INFORMATION: EXAMPLE: SCEL-8000-S-R-AL-ZD-HO-RC-U

MODEL	VOLTAGE	LETTER COLOR	EXIT PANEL BACKGROUND	TRIM PLATE FINISHED	FUNCTION	BATTERY CAPACITY	REMOTE CAPABILITY	PANEL NUMBER
SCEL-8000	S Single face	R Red	BLANK Clear	AL Aluminum	BLANK Standard Circuitry	BLANK 3.6V 1800mAh 250Lm output	BLANK No Remote capability	BLANK Standard Type
	D Double face	G Green	(M) Mirrored	WH White	CT Self-diagnostic	HO 3.6V 2500mAh 400Lm output	RC 3.6V max. 3W remote capability	U Providing additional EXIT
				BK Black	ZD CT with Wireless Reporting LynxEM Control			

- * Double Face (only for mirror background)
- * Single Face (both for clear and mirrored background)

PRODUCT DIMENSION

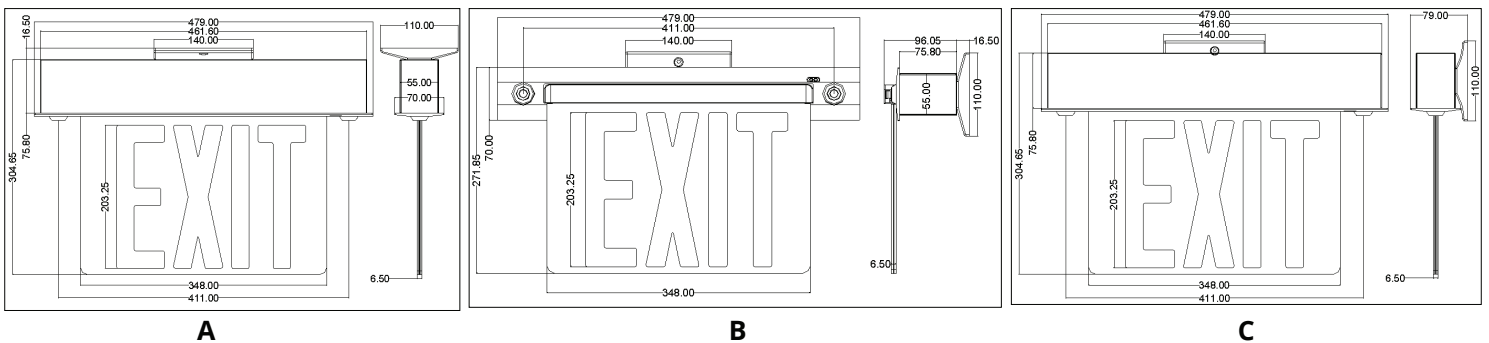

SCEL-8000

Exit Sign & Emergency Lighting

LUMINOUS INTENSITY DISTRIBUTION

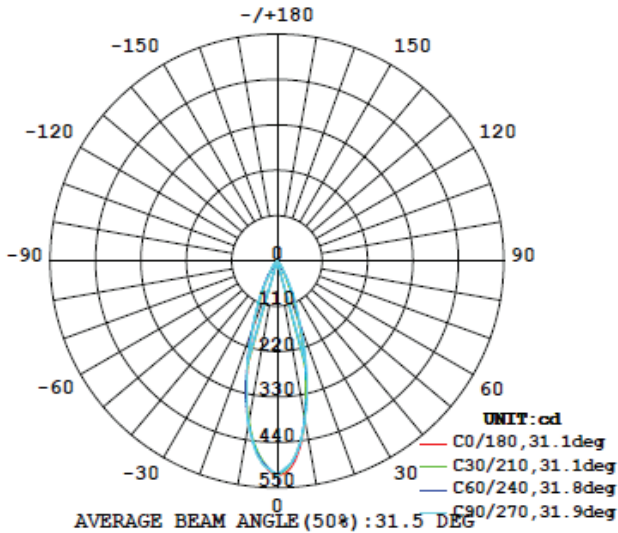

Project Name:	
Type:	

CENTER TO CENTER SPACING

NFPA 101 requires 1.0 foot-candle average and 0.1 foot-candle minimum with a 40:1 maximum/minimum ratio. The corridor used is 100 feet long, 9 feet ceiling with a 6 feet wide walkway and 3 feet path of egress.

The reflectance are 80% ceiling, 50% walls and 20% floor. The fixture mounting height is 7.5 feet.

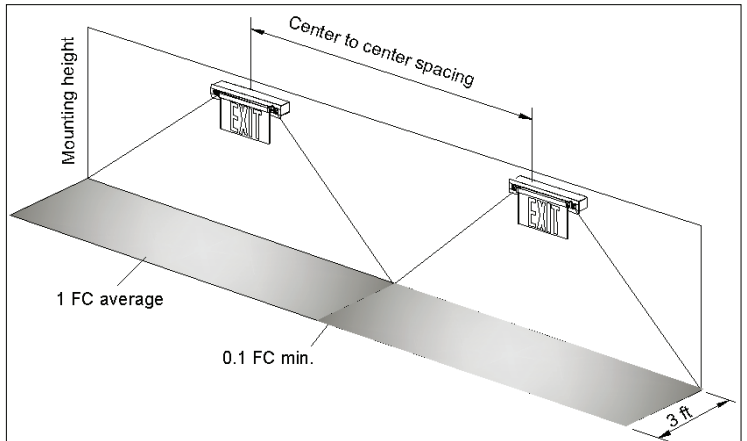

No.	MODEL	SPACING @ 7.5 FEET MOUNTING HEIGHT	SPACING @ 10 FEET MOUNTING HEIGHT
1	SCEL-8000-X	34 feet	40 feet
2	SCEL-8000-X-HO	42 feet	48 feet

PRODUCT ASSEMBLY EXPLODED

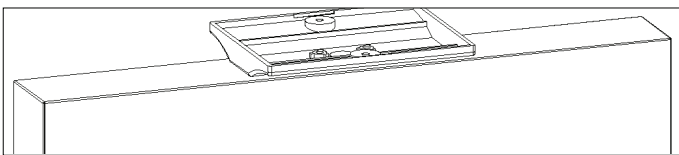

Step1: Install canopy to junction box.

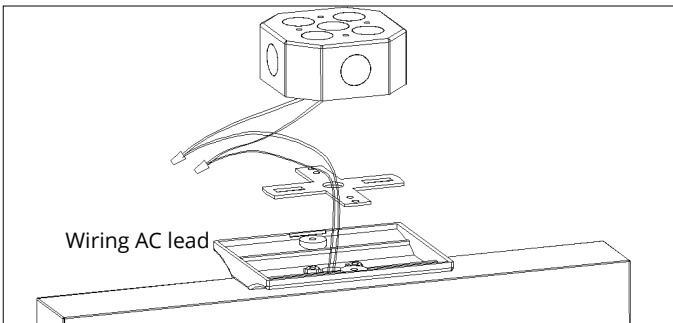

Step2: Wiring AC lead to outlet box, fixed the unit to outlet box

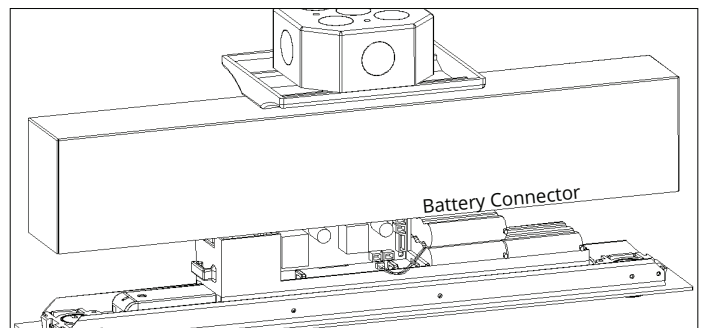

Step3: Separate trim module and connect battery connector to PCBA

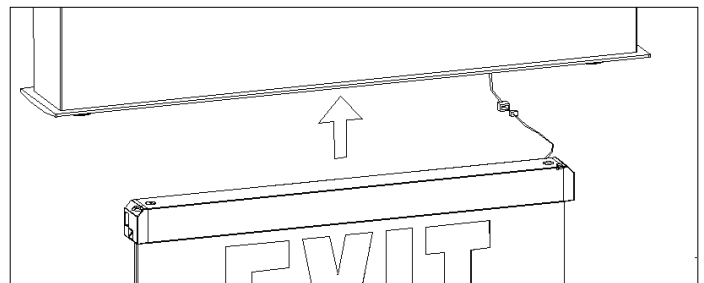

Step4: Push the unit back to the junction box, assembly panel module

Project Name:	
Type:	

SCEL-8000

Exit Sign & Emergency Lighting

SURFACE CEILING OR SURFACE WALL MOUNT

SURFACE CEILING MOUNT

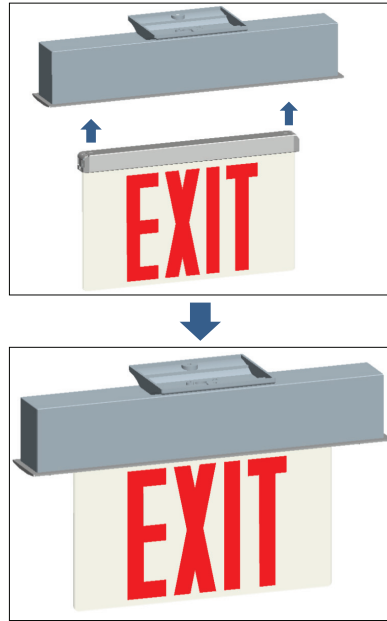

SURFACE WALL MOUNT I

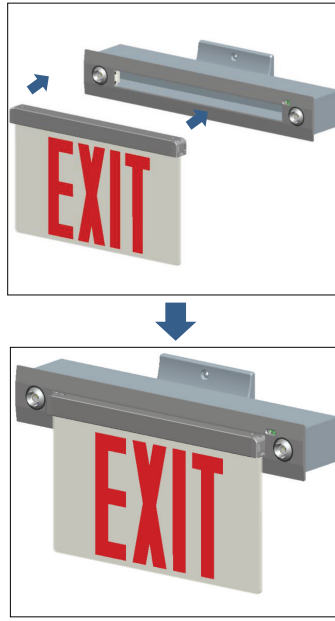

SURFACE WALL MOUNT II

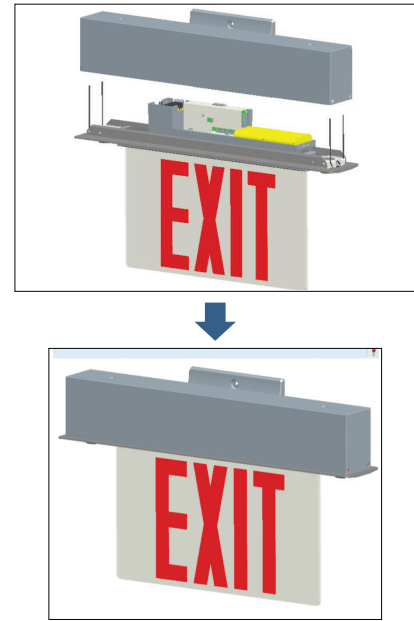

PACKAGING

INNER BOX : 515x260x110mm
 CARTON BOX : 530x445x240mm
 Q'TY : 4 PCS
 N.W : 10.3 KGS
 G.W : 12.4 KGS
 MEA'S : 2.42 CUFT

