

EXL-700

LED Emergency Light
Wireless Reporting Compatible

PRODUCT FEATURE

HOUSING

- Injection molded thermoplastic ABS housing
- Plastic enclosure with 5VA flame retardant
- Quick connector design for easy installation
- Two fully adjustable glare-free square shape light heads for emergency light



ELECTRICAL

- AC 120/277VAC dual voltage operation
- Test switch and charge rate indicator
- Self-test and Self-diagnostics function is available for battery backup model
- 3.6V long life, maintenance-free, rechargeable Ni-cad battery
- 24 hours recharge after 90 minutes discharge

MOUNTING

- Suitable for wall mount and ceiling mount
- Top and side knockout for conduit applications

LISTING

- Suitable for use in 10°C - 40°C ambient temperature, suitable for damp location
- UL listed meets or exceed all requirement in NFPA 70, NFPA 101 life safe code
- Compliant CEC title 20 efficiency regulations

OPTIONS

- CT option with self-testing and self-diagnostics
- RC option with 3.6V 3W max remote capability
- ZD option with Wireless testing and Reporting function
- Multi voltage option with 220-240VAC 50Hz input

WARRANTY

- See [Limited Warranty Policy](#) for more additional information

RELATED PRODUCTS

- 🔗 [EXL-1960 Emergency Light](#)
- 🔗 [EXL-660 Emergency Light](#)
- 🔗 [WEXH-900L & 910L Emergency Light](#)
- 🔗 [WMU Series Wet & Cold location](#)

ORDER INFORMATION: **EXAMPLE:** EXL-700-HORC-ZD-B-3

EXL-700	-		-		-		-	
MODEL	LUMEN OUTPUT & REMOTE CAPABILITY		TEST FACILITY		HOUSING COLOR		VOLTAGE	
EXL-700	BLANK	Standard lumen output, no remote capability	BLANK	Manual test	W	White	1	120/277V
	RC	Standard lumen output, with remote capability	CT	Self-testing/ Self-diagnostics	B	Black	3	220-240 ⁽¹⁾
	HO	High lumen output, w/o remote capability	ZD	Wireless Reporting LynxEM® Control				
	HORC	High lumen output, with remote capability						
	HO6	Total 540lm@6W						

EXL-700

LED Emergency Light
Wireless Reporting Compatible

PRODUCT DIMENSION

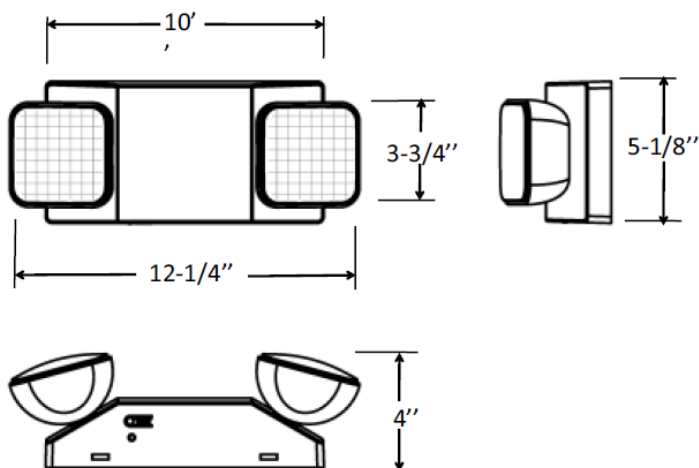

PHOTOMETRIC

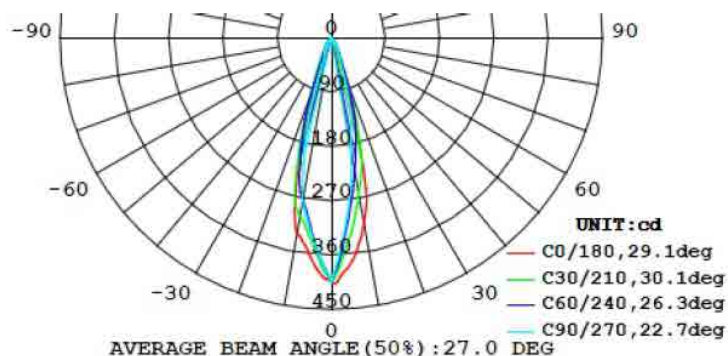

CENTER TO CENTER SPACING

NFPA 101 requires 1.0 foot-candle average and 0.1 foot-candle minimum with a 40:1 maximum/ minimum ratio. The corridor used is 100 feet long, 9 feet ceiling with a 6 feet wide walkway and 3 feet path of egress.

The reflectance are 80% ceiling, 50% walls and 20% floors. The fixture mounting height is 7.5 feet.

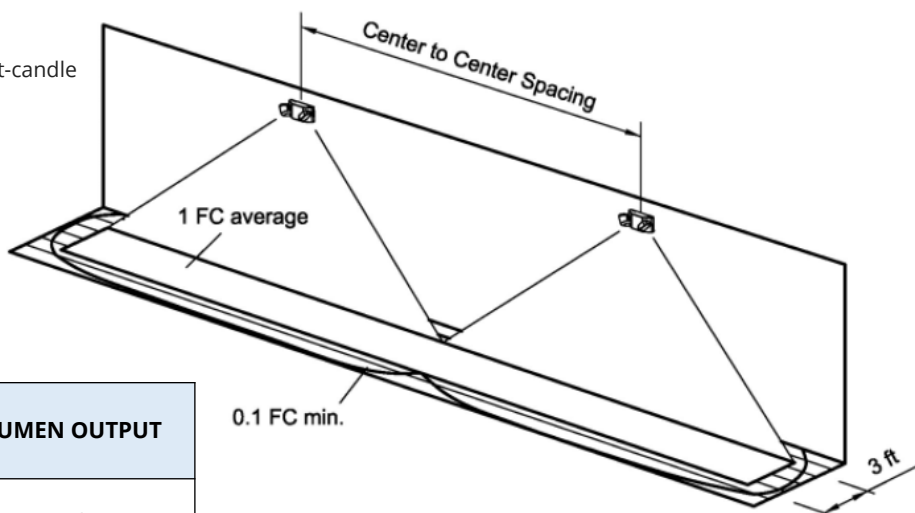

MODEL	CENTER TO CENTER SPACING	LUMEN OUTPUT
EXL-700	24FT	200lm
EXL-700-HO	30FT	300lm
EXL-700-HO6	50FT	540lm

EXL-700

LED Emergency Light
Wireless Reporting Compatible

Project Name:	
Type:	

REMOTE HEADS



EXH-701-HO

- Single remote head, 3.6VDC 1.5W delivers 120lm per unit
- Operation temperature range 10°C...+40°C
- Suitable for damp location
- UL, cUL listed



EXH-701

- Single remote head, 3.6VDC 1W delivers 75lm per unit
- Operation temperature range 10°C...+40°C
- Suitable for damp location
- UL, cUL listed



EXH-702-HO

- Dual remote heads, 3.6VDC 3W delivers 240lm per unit
- Operation temperature range 10°C...+40°C
- Suitable for damp location
- UL, cUL listed



EXH-702

- Dual remote heads, 3.6VDC 2W delivers 150lm per unit
- Operation temperature range 10°C...+40°C
- Suitable for damp location
- UL, cUL listed

PACKAGING

Q'TY : 6 PCS
N.W : 4.80 KGS
G.W : 6.50 KGS
MEA'S : 1.35 CUFT

