

REVISIONS		
REV	DESCRIPTION	DATE
00	RELEASE	11/19/2020

MCA-150

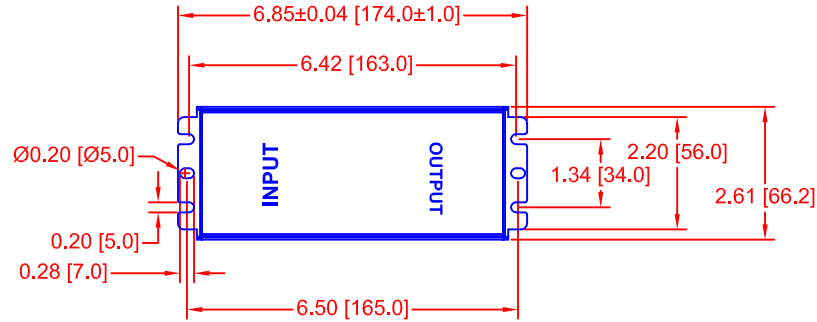

MCA-105 & MCA-120

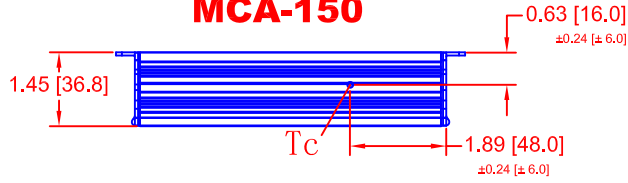
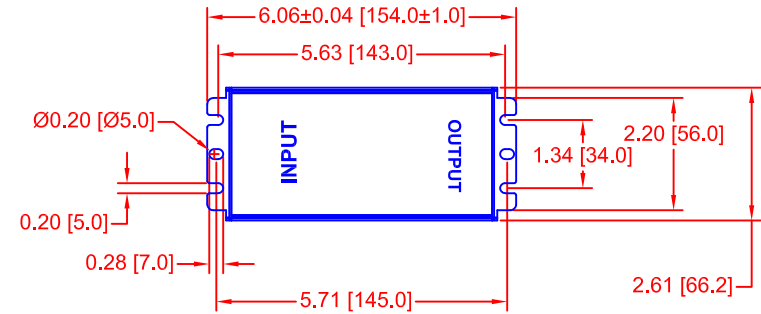
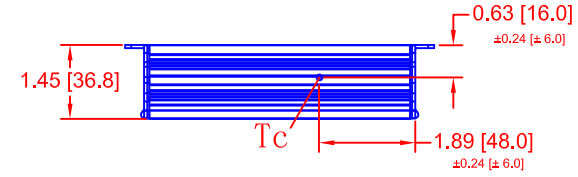

T_c=90°C

MCA-200

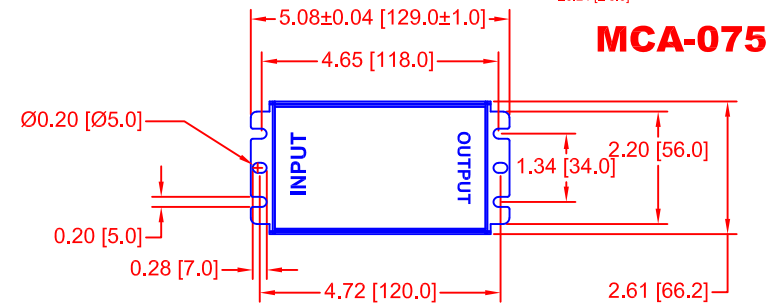
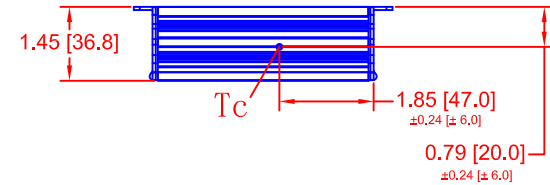
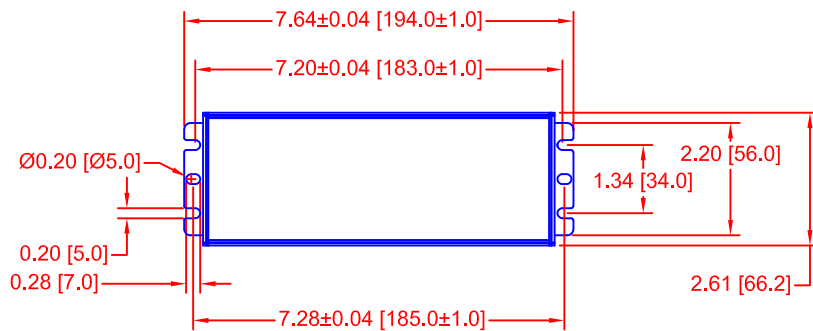
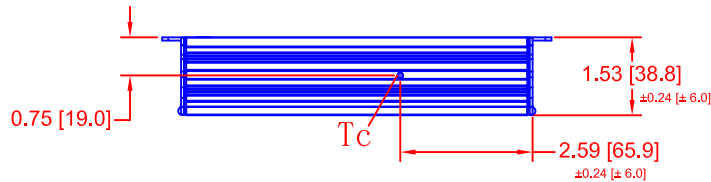

MCA-075

MANUFACTURED BY:

THIS ITEM IS THE PROPERTY OF MAGTECH INDUSTRIES AND CONTAINS PROPRIETARY CONFIDENTIAL AND TRADE SECRET INFORMATION. THE INFORMATION CONTAINED HEREIN MUST NOT BE USED, DISCLOSED OR REPRODUCED IN WHOLE OR IN PART WITHOUT PRIOR WRITTEN CONSENT FROM MAGTECH INC.

UNLESS OTHERWISE SPECIFIED DIMENSIONS IN INCHES (MM) TOLERANCES: XX DECIMALS: .05 (1.3) XXX DECIMALS: .02 (0.5) XXX DECIMALS: .005 (0.13) ANGLES: 1° FRACTIONS: 1/16	QC:	
DO NOT SCALE THIS DRAWING INTERPRET DRAWING PER ANSI Y14.5M	APPROVAL DATE: 11/19/2020 EFFECTIVE DATE: 11/19/2020	
TITLE: DRAWING, T _c POINT MCA075, MCA105, MCA120, MCA150, MCA200		MODEL NO. DWG NO. 07-0228 REV. 00 SH. OF 1 1